

# MOCCA XS DIM

“Mocca - The all-in-one cylindrical solution. Mocca is our interpretation of an all integrated cylindrical spotlight. The cooling is passive, being all silent, by allowing cold air to flow from the middle of the cylinder and out in the back. By choosing Mocca you will get a uncluttered environment focusing on the essential: The simplicity of the spotlight and the effect of the light. Developed and produced in Sweden”.

LED-spotlight with interchangeable LED lamp GU10.  
 Die cast aluminium body, powder coat painted.  
 Black or gold anodised anti-glare diffuser.  
 Including LED lamp GU10.  
 Dimmable via phase-cut.  
 Rotation 360°. Vertical adjustment +/- 90°.  
 Track mounted with 3-circuit adapter.



<b>Class of protection</b>	IP20, class I
<b>Colours</b>	White, black
<b>Weight total</b>	430g
<b>Reflector</b>	High purity aluminium
<b>Lifetime</b>	40.000h L70/B10 at Ta 25°C
<b>Mounting</b>	3-circuit universal adaptor
<b>Voltage</b>	220-240V 50/60hz
<b>Qty per MCB</b>	
<b>Colour consistency</b>	3 SDCM
<b>Photobiological safety</b>	RG1
<b>Design</b>	Jesper Ståhl
<b>Dimming</b>	Phase-cut 100-20%



- White
- Black

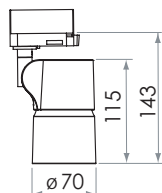

# MOCCA XS DIM

Description	Reflector	Cone	LIGHTSOURCE		Load	Lumen	Lm/W	LUMINAIRE																																					
			CCT (K)	CRI				○ White	● Black																																				
								ART. No.																																					
WARM WHITE 2700K (927)																																													
MOCCA XS Dim 500lm ME 927	Medium 25°		2700K	97	5W	385	74	<b>221102</b>	<b>221202</b>																																				
MOCCA XS Dim 500lm FL 927	Flood 36°		2700K	97	5W	385	74	<b>221103</b>	<b>221203</b>																																				
MOCCA XS Dim 500lm gold ME 927	Medium 25°	Gold	2700K	97	5W	385	74	<b>221302</b>	<b>221402</b>																																				
MOCCA XS Dim 500lm gold FL 927	Flood 36°	Gold	2700K	97	5W	385	74	<b>221303</b>	<b>221403</b>																																				
								<table border="1"> <thead> <tr> <th colspan="3">Medium 25°</th> <th colspan="3">Flood 36°</th> </tr> <tr> <th>m</th> <th>∅</th> <th>Lux</th> <th>m</th> <th>∅</th> <th>Lux</th> </tr> </thead> <tbody> <tr> <td>1.0</td> <td>0,44</td> <td>1090</td> <td>1.0</td> <td>0,59</td> <td>841</td> </tr> <tr> <td>1.5</td> <td>0,67</td> <td>484</td> <td>1.5</td> <td>0,89</td> <td>374</td> </tr> <tr> <td>2.0</td> <td>0,89</td> <td>273</td> <td>2.0</td> <td>1,18</td> <td>210</td> </tr> <tr> <td>2.5</td> <td>1,11</td> <td>174</td> <td>2.5</td> <td>1,48</td> <td>135</td> </tr> </tbody> </table>		Medium 25°			Flood 36°			m	∅	Lux	m	∅	Lux	1.0	0,44	1090	1.0	0,59	841	1.5	0,67	484	1.5	0,89	374	2.0	0,89	273	2.0	1,18	210	2.5	1,11	174	2.5	1,48	135
Medium 25°			Flood 36°																																										
m	∅	Lux	m	∅	Lux																																								
1.0	0,44	1090	1.0	0,59	841																																								
1.5	0,67	484	1.5	0,89	374																																								
2.0	0,89	273	2.0	1,18	210																																								
2.5	1,11	174	2.5	1,48	135																																								
WARM WHITE 3000K (930)																																													
MOCCA XS Dim 500lm ME 930	Medium 25°		3000K	97	5W	405	78	<b>221106</b>	<b>221206</b>																																				
MOCCA XS Dim 500lm FL 930	Flood 36°		3000K	97	5W	405	78	<b>221107</b>	<b>221207</b>																																				
MOCCA XS Dim 500lm gold ME 930	Medium 25°	Gold	3000K	97	5W	405	78	<b>221306</b>	<b>221406</b>																																				
MOCCA XS Dim 500lm gold FL 930	Flood 36°	Gold	3000K	97	5W	405	78	<b>221307</b>	<b>221407</b>																																				
								<table border="1"> <thead> <tr> <th colspan="3">Medium 25°</th> <th colspan="3">Flood 36°</th> </tr> <tr> <th>m</th> <th>∅</th> <th>Lux</th> <th>m</th> <th>∅</th> <th>Lux</th> </tr> </thead> <tbody> <tr> <td>1.0</td> <td>0,44</td> <td>1147</td> <td>1.0</td> <td>0,59</td> <td>885</td> </tr> <tr> <td>1.5</td> <td>0,67</td> <td>510</td> <td>1.5</td> <td>0,89</td> <td>393</td> </tr> <tr> <td>2.0</td> <td>0,89</td> <td>287</td> <td>2.0</td> <td>1,18</td> <td>221</td> </tr> <tr> <td>2.5</td> <td>1,11</td> <td>183</td> <td>2.5</td> <td>1,48</td> <td>142</td> </tr> </tbody> </table>		Medium 25°			Flood 36°			m	∅	Lux	m	∅	Lux	1.0	0,44	1147	1.0	0,59	885	1.5	0,67	510	1.5	0,89	393	2.0	0,89	287	2.0	1,18	221	2.5	1,11	183	2.5	1,48	142
Medium 25°			Flood 36°																																										
m	∅	Lux	m	∅	Lux																																								
1.0	0,44	1147	1.0	0,59	885																																								
1.5	0,67	510	1.5	0,89	393																																								
2.0	0,89	287	2.0	1,18	221																																								
2.5	1,11	183	2.5	1,48	142																																								
NEUTRAL WHITE 4000K (940)																																													
MOCCA XS Dim 500lm ME 940	Medium 25°		4000K	97	5W	430	83	<b>221110</b>	<b>221210</b>																																				
MOCCA XS Dim 500lm FL 940	Flood 36°		4000K	97	5W	430	83	<b>221111</b>	<b>221211</b>																																				
MOCCA XS Dim 500lm gold ME 940	Medium 25°	Gold	4000K	97	5W	430	83	<b>221310</b>	<b>221410</b>																																				
MOCCA XS Dim 500lm gold FL 940	Flood 36°	Gold	4000K	97	5W	430	83	<b>221311</b>	<b>221411</b>																																				
								<table border="1"> <thead> <tr> <th colspan="3">Medium 25°</th> <th colspan="3">Flood 36°</th> </tr> <tr> <th>m</th> <th>∅</th> <th>Lux</th> <th>m</th> <th>∅</th> <th>Lux</th> </tr> </thead> <tbody> <tr> <td>1.0</td> <td>0,44</td> <td>1090</td> <td>1.0</td> <td>0,59</td> <td>841</td> </tr> <tr> <td>1.5</td> <td>0,67</td> <td>484</td> <td>1.5</td> <td>0,89</td> <td>374</td> </tr> <tr> <td>2.0</td> <td>0,89</td> <td>273</td> <td>2.0</td> <td>1,18</td> <td>210</td> </tr> <tr> <td>2.5</td> <td>1,11</td> <td>174</td> <td>2.5</td> <td>1,48</td> <td>135</td> </tr> </tbody> </table>		Medium 25°			Flood 36°			m	∅	Lux	m	∅	Lux	1.0	0,44	1090	1.0	0,59	841	1.5	0,67	484	1.5	0,89	374	2.0	0,89	273	2.0	1,18	210	2.5	1,11	174	2.5	1,48	135
Medium 25°			Flood 36°																																										
m	∅	Lux	m	∅	Lux																																								
1.0	0,44	1090	1.0	0,59	841																																								
1.5	0,67	484	1.5	0,89	374																																								
2.0	0,89	273	2.0	1,18	210																																								
2.5	1,11	174	2.5	1,48	135																																								

Luminous flux and connected electrical load are subject to an initial tolerance of +/- 5%. Tolerance of colour temperature: +/-150 K. Tolerance of CRI +/- 1,5. Values apply to an ambient temperature of 25°C.